



MH 302

- Tangential flow design Self-cleaning,
- Clog-resistant design
- Homogeneous spray coating



Assembly  
MH302-1



Assembly  
MH302-2



MF 303

- Tangential flow design
- Unaffected by transient pressures
- Extremely uniform liquid distribution



Assembly  
MH303-1

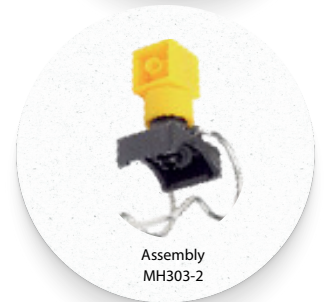

Assembly  
MH303-2

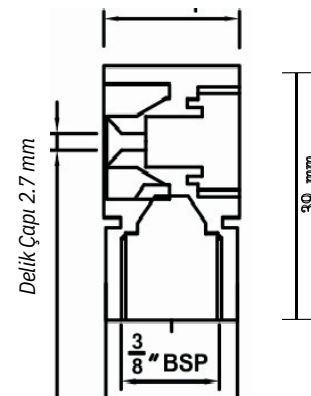
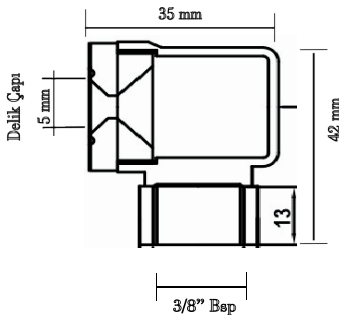
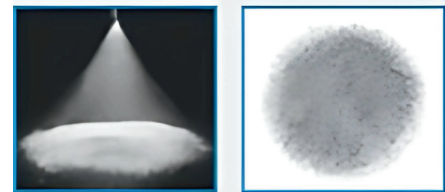
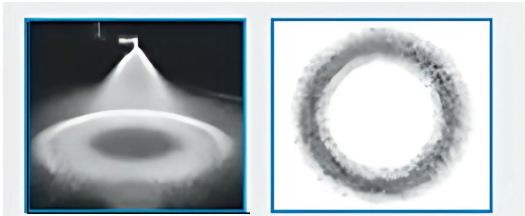

**Fields of Application**

- Surface Spraying Dust Control
- Pipe Cooling During Pvc/Hdpe Pipe Extrusion
- Cleaning and Washing Process
- Degreasing and Phosphating
- Foam Control for Storage Tanks

Spray angle @ 3 bar	Nozzle Code	Hole Diameter (mm)	Nozzle Flow Rate	Spray Pressure						
				0.6 bar	1.3 bar	2.0 bar	3.0 bar	4.0 bar	5.0 bar	7.0 bar
90°	MF 303	2,6	[l/min]	1.84	2.76	3.28	3.80	4.70	5.42	5.99
			[gal/min]	0.49	0.73	0.87	1.01	1.24	1.43	1.58
	MH 302	5.00	[l/min]	2.50	3.00	3.42	4.15	5.15	6.00	6.80
			[gal/min]	0.66	0.79	0.90	1.09	1.36	1.58	1.79